

技术参数:

- 针数: 8+PE
- 额定电流(40°C): 20 A
- 额定电压: 400 V
- 脉冲电压: 6 KV
- 污染等级: 3
- 绝缘电阻:  $\geq 10^{10} \Omega$
- 阻燃等级 UL94: V0
- 插拔次数:  $\geq 500$
- 材料: PA
- 使用温度范围:  $-40^{\circ}\text{C} - +100^{\circ}\text{C}$

Technical specification:

- Rated voltage: 8+PE
- Rated current (40°C): 20 A
- Rated voltage: 400 V
- Rated impulse voltage: 6 KV
- Pollution degree: 3
- Insulation resistance:  $\geq 10^{10} \Omega$
- Flammability acc.to UL 94: V0
- Mating cycles:  $\geq 500$
- Material: PA
- temperature range:  $-40^{\circ}\text{C} - +100^{\circ}\text{C}$

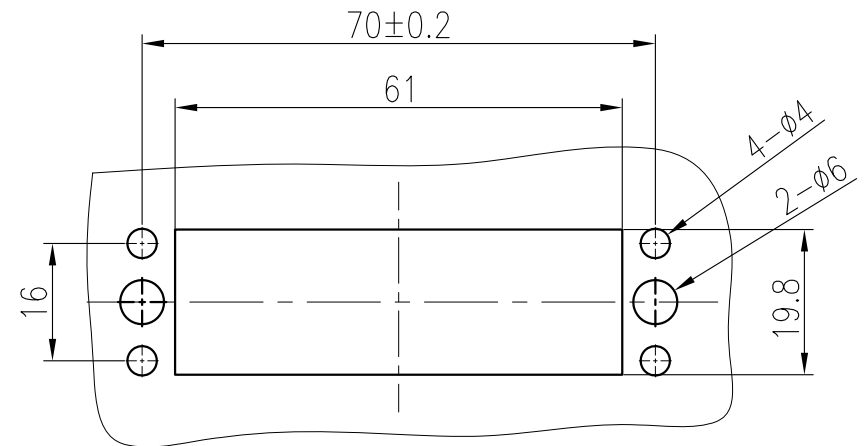
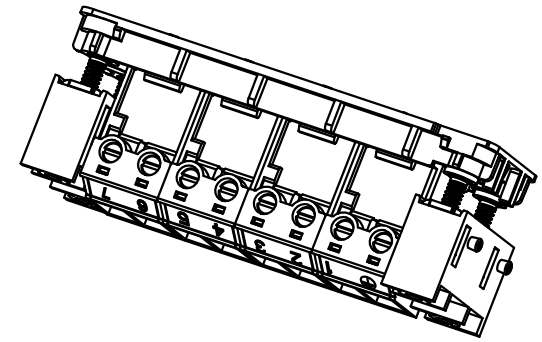
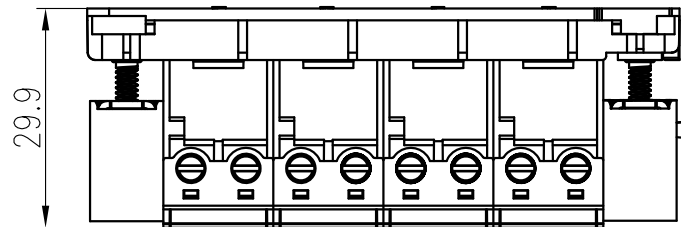
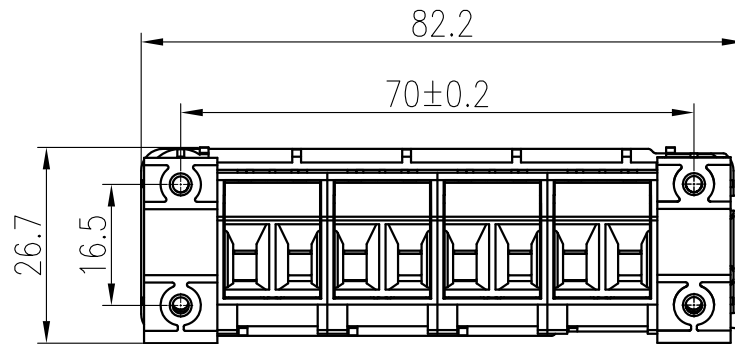

面板开孔图 Panel cut out

|               |              |                  |                |                 |            |   |            |   |            |                        |  |
|---------------|--------------|------------------|----------------|-----------------|------------|---|------------|---|------------|------------------------|--|
|               |              |                  |                | 表面处理<br>Finish  |            | -   |            | 图号<br>Drawing No.                           |            | -                      |  |
|               |              |                  |                | 材料<br>Material  |            | -   |            | 产品代号<br>Part Code                           |            | HV-AF3/4M-PEA<br>-S222 |  |
| 标记<br>Mark    | 处数<br>Number | 变更描述/Description |                | 签名<br>Signature | 日期<br>Date |   |            | 产品料号<br>Part No.                            |            | 1320080110001          |  |
|               | 姓名/Name      | 日期/Date          |                | 姓名/Name         | 日期/Date    | 比例<br>Scale                                   | 版本<br>REV. | 重量<br>Weight                                | 数量<br>Qty. | 产品名称<br>Part Name      |  |
| 绘图<br>Drawn   | CH CHEN      | 11.12.2016       | 标准化<br>Stand.  | -               | -          | 1:1   | V1.0       | 49.1g                                       | -          | -                      |  |
| 审核<br>Checked | ZM LIN       | 11.12.2016       |                |                 |            |   |            |   |            | -                      |  |
| 工艺<br>Process | -            | -                | 批准<br>Approved | YY LUO          | 11.12.2016 | All Dimensions in mm<br>Original Size DIN A 4 |            | 厦门唯恩电气有限公司<br>XIAMEN WAIN ELECTRICAL CO.LTD |            |                        |  |